

K-2E is 5000 IN 1 universal A/C remote control. This model build-in Clock, Timer On/Off, Quickly Search, Brands Search functions. And it can directly control 4 brands A/C (MITSUBISHI, GREE, MIDEA, Panasonic National) without any setup when insert batteries.

Setting Method

Turn on you're A/C, let the remote control aim the A/C receive window.

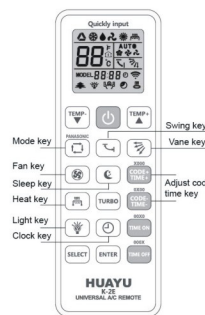

1. Turn on your A/C manually, and find out your brand code from the code list. One brand may have many codes, you can choose the first set code. (if no work, then choose next set, till you find the correct code.)
2. Press "SELECT" button and "ENTER" button together, the remote control will come into setting mode, code display "----" and flash on the screen.

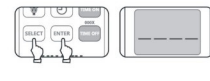

- Press "CODE+/-" / "TIME+" for setting thousands digit
- Press "CODE+/-" / "TIME+" for setting tens digit
- Press "TIMER ON" for setting tens digit
- Press "TIMER OFF" for setting units digit

3. If the code can work well, press "ENTER" for saving code. Remark: If there is no any operation at the remote control within 15s, it will exit setting mode and not save the code.

1. Let the remote control aim the A/C receive window, press "SELECT" for 3s, then the remote control will come into setting mode, and the remote control will send one code by each click on "SELECT" button, when the A/C has reaction, press "ENTER" for confirmation and saving code.



2. Let the remote control aim the A/C receive window again for testing other buttons function, if the code is invalid, make the setting again according to above method. Remark: If there is no any operation at the remote control within 15s, it will exit setting mode and not save the code.

Method C: Quickly auto search code

1. press and hold "SELECT" button, don't release the button, the remote control will come into auto search mode, code will display "----" and flash on screen, when the A/C has reaction, release "SELECT" button at once, setting to be finished.

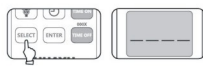

2. Let the remote control aim the A/C receive window again for testing other buttons function, if the code is invalid, make the setting again according to above method.

(Remark: this remote control build-in intelligent speed function. If after setting, you feel the remote control operation not so fast for A/C, you can press "ENTER" button and don't release, when the A/C has reaction, release the button, then test the remote control again.)

Method D: Brand search

press the corresponding key of brand and don't release, when the A/C has reaction, release the button at once. Test the functions are ok or not, if it is invalid, please reset again. Remark: the screen will display the code "----" and flash when you make setting, release the button, it will display current code.

The brand list for corresponding key

1)MODE:	PANASONIC
2)SWING:	SANYO
3)VANE:	MITSUBISHI
4)FAN:	TOSHIBA
5)HEAT:	SHARP
6)CODE+/TIME+:	SAMSUNG
7)CODE-/TIME-:	LG
8)TIMER ON:	DAIKIN
9)TIMER OFF:	HITACHI
10)LIGHT:	ELECTROLUX
11)CLOCK:	FUJITSU
12)SLEEP:	CARRIER

Clock Function

Press "CLOCK" button, time will be started flashing.

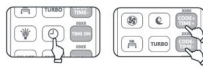

Press "CLOCK" button again, time will be stopped flashing, setting to be finished. (or it will auto confirm after 8s if don't have other operation.)

Timing Function

1. press "TIME ON" button, the time of "TIME ON" will flash,

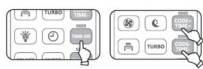

3. press "TIME OFF" button, the time of "TIME OFF" will flash,



REMARK:

1. can adjust time range: 24 hours
2. Continuously press "TIME ON" or "TIME OFF" two times, it will cancel "TIME ON" or "TIME OFF", time for "TIME ON" or "TIME OFF" will disappear from the screen.
3. after setting timing function, you need to let the remote control aim the A/C receive window, otherwise the time is invalid.

Factory reset function

1. press "SELECT" button and "POWER" button together.
2. about 5s, the whole screen will light 1s, all setting will back to factory initial mode.

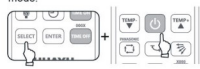

Children lock function

Press SELECT button and fan speed button together for lock or unlock.

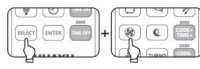

REMARK: It will can't make any setting after lock.

※ This company reserves the right to interpretation of the User's Manual. Design and technical parameters may vary without notice.

K-3E is 5000 IN 1 universal A/C remote control. This model build-in Clock, Timer On/Off, Quickly Search, Brands Search functions. And it can directly control 4 brands A/C (MITSUBISHI, GREE, MIDEA, Panasonic National) without any setup when insert batteries.

Setting Method

Turn on you're A/C, let the remote control aim the A/C receive window.

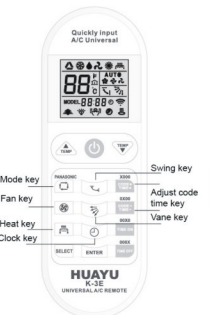

1. Turn on your A/C manually, and find out your brand code from the code list. One brand may have many codes, you can choose the first set code. (if no work, then choose next set, till you find the correct code.)
2. Press "SELECT" button and "ENTER" button together, the remote control will come into setting mode, code display "----" and flash on the screen.

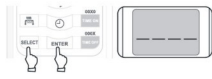

- Press "CODE+/-" / "TIME+" for setting thousands digit
- Press "CODE+/-" / "TIME+" for setting tens digit
- Press "TIMER ON" for setting tens digit
- Press "TIMER OFF" for setting units digit

3. If the code can work well, press "ENTER" for saving code. Remark: If there is no any operation at the remote control within 15s, it will exit setting mode and not save the code.

1. Let the remote control aim the A/C receive window, press "SELECT" for 3s, then the remote control will come into setting mode, and the remote control will send one code by each click on "SELECT" button, when the A/C has reaction, press "ENTER" for confirmation and saving code.



2. Let the remote control aim the A/C receive window again for testing other buttons function, if the code is invalid, make the setting again according to above method. Remark: If there is no any operation at the remote control within 15s, it will exit setting mode and not save the code.

Method C: Quickly auto search code

1. press and hold "SELECT" button, don't release the button, the remote control will come into auto search mode, code will display "----" and flash on screen, when the A/C has reaction, release "SELECT" button at once, setting to be finished.



2. Let the remote control aim the A/C receive window again for testing other buttons function, if the code is invalid, make the setting again according to above method.

(Remark: this remote control build-in intelligent speed function. If after setting, you feel the remote control operation not so fast for A/C, you can press "ENTER" button and don't release, when the A/C has reaction, release the button, then test the remote control again.)

Method D: Brand search

press the corresponding key of brand and don't release, when the A/C has reaction, release the button at once. Test the functions are ok or not, if it is invalid, please reset again. Remark: the screen will display the code "----" and flash when you make setting, release the button, it will display current code.

The brand list for corresponding key

1)MODE:	PANASONIC
2)SWING:	SANYO
3)VANE:	MITSUBISHI
4)FAN:	TOSHIBA
5)HEAT:	SHARP
6)CODE+/TIME+:	SAMSUNG
7)CODE-/TIME-:	LG
8)TIMER ON:	DAIKIN
9)TIMER OFF:	HITACHI
10)CLOCK:	FUJITSU

Clock Function

Press "CLOCK" button, time will be started flashing.



Press "CLOCK" button again, time will be stopped flashing, setting to be finished. (or it will auto confirm after 8s if don't have other operation.)

Timing Function

1. press "TIME ON" button, the time of "TIME ON" will flash,



3. press "TIME OFF" button, the time of "TIME OFF" will flash,



REMARK:

1. can adjust time range: 24 hours
2. Continuously press "TIME ON" or "TIME OFF" two times, it will cancel "TIME ON" or "TIME OFF", time for "TIME ON" or "TIME OFF" will disappear from the screen.
3. after setting timing function, you need to let the remote control aim the A/C receive window, otherwise the time is invalid.

Factory reset function

1. press "SELECT" button and "POWER" button together.
2. about 5s, the whole screen will light 1s, all setting will back to factory initial mode.



Children lock function

Press SELECT button and fan speed button together for lock or unlock.



REMARK: It will can't make any setting after lock.

※ This company reserves the right to interpretation of the User's Manual. Design and technical parameters may vary without notice.

Applicable Brand and Code List

Brand	Model Code
ALPIN	0252-0253, 1277, 1790
AIRWELL	0555, 0556, 1250, 1856
AUCMA	0298-0296, 0615-0616, 0675, 1679
AUX	0297-0300, 0679, 0692, 1834, 3090
BOERKA	0383, 0434, 0436-0437, 1773
CARRIER	0203-0209, 0482-0486, 0563, 0564, 0565
CHANGHONG	0301-0308, 0617-0619, 0636, 2350, 3088
CHIGO	0379-0382, 0515, 0648-0653, 1915, 2990
CHOFU	0184-0187, 1574, 3658
CHUNLAN	0345-0350, 0453, 0620-0637, 2220, 2435, 3132
CORONA	0155-0163, 0459, 0858, 2250, 2998
COMFOR STAR	0613, 1123, 1308, 2269, 2478, 3001
CONROWA	0377, 0899, 1315, 2939, 3517, 3972
DAIKIN	0171-0183, 0566, 0567, 0583, 0621-0625
DECODING	0647, 1344, 2741, 2598, 3549
DOCTOR	0221, 0449, 1475, 3807, 3896
DONGBAO	0355-0361, 1888, 2990, 2991, 3147
DONGXINBAO	0413, 0874, 0983, 1236, 1489, 1975

Brand	Model Code
ELECTRA	0557, 1252, 1947, 2642
Electrolux	0216-0220, 0560, 0569, 0594-0598, 1255
FEDDERS	0528, 1223, 1227, 3145
FRESTECH	0277, 0519, 0520, 0601, 0602, 0655, 0972, 1214, 1350
FUJITSU	0127-0137, 0552, 0553, 0554, 0626, 0681-0682, 1247, 1525, 2212
FUNAI	0430, 0481, 1125, 2684
GUOQIAO	0244, 0491, 0939, 1116, 3999
GALANZ	0371-0372, 0521, 0638-0639, 1066, 2457
GLEE	0398-0399, 0934
GOLDSTAR	0201, 0466-0469, 0572, 0600, 1591
GREE	0309-0316, 0512, 0513, 0689-0691, 0693
HAIER	0266-0272, 0627-0628, 0694, 1457
HISENSE	0332-0335, 0517, 0609, 0610, 0632
HITACHI	0118-0126, 0500, 0501, 0665-0674
HUABAO	0336-0344, 0641, 2384, 2903
HUAKE	0408, 0920, 1501, 3480
HUAMEI	0402, 0460-0465, 2962, 3986
HUALING	0317-0325, 0629-0631, 2365, 3524
HUIFENG	0370, 2418, 3442

Brand	Model Code
HUIKANG	0368, 0441-0443, 1978, 3440
HYUNDAI	0202, 0433, 0551, 3552
JDC	0373, 0440, 2488, 3957
JIANGNAN A/C	0432
JINDA	0414, 1479, 3678
JINSONG	0389-0391, 0446-0448, 2028, 3829
JOHNSON	0245, 0492, 3487, 3543
KANGLI	0374-0375, 1069, 2442
KELON	0282-0287, 0606, 0642-0643
KLIMATAIR	0225-0226, 0452, 3297
KOLIN	0416-0418, 2466, 3488
KONKA	0397, 0457-0459, 3017
LEHUA	0369, 0438-0439, 2258, 3712
LG	0197-0200, 0504, 0514, 0677, 0684-0685, 2248
LIANGYU	0233, 0451, 1987, 2149
LITTLE DUCK	0530, 1014, 2736, 3698, 3746
LOREN-SEBO	0255, 0471, 0472, 2009, 3637
MACQUAY	0234-0237, 0465, 1489, 2746
MIDEA	0260-0265, 0526, 0631, 0686-0688
MINGXING	0590
MITSUBISHI	0000-0045, 0476-0479, 0547, 0558, 0568, 0582, 0591, 0645, 0646

Brand	Model Code
NORITZ	0431, 3211
OMEGA	0559, 3214, 3256, 3589
Panasonic National	0138-0154, 0658-0660, 0676, 2919
PANDA	0378, 0963, 1592, 3844
PHILCO	0210-0211, 0487-0490, 3967
PROTON	0421-0423, 2153
RAYBO	0362-0367, 2410, 3439
ROWA	0527, 0531, 0644
Sabro	0435, 0506-0508, 0948, 3588
SAIJO DENKI	0212-0215, 0725, 2252
SAMPO	0424-0426, 1150, 3699
SAMSUNG	0188-0196, 0503, 0518, 0661-0664, 0680
SANYO	0046-0095, 0529, 0604, 0605, 0683, 1070
SASUKI	0254, 0470, 1494, 2819
SAST	0633
SHANGLING	0384-0388, 0444-0445, 3409
SHANXING	0392, 0449, 1596, 3184
SHARP	0096-0106, 0525, 0603, 0634, 0678, 1122
SHENGFENG SHUANGLU	0376, 0480
SHINCO	0351-0354, 0454-0456, 1046, 1742
SHUANGLU	0404-0407, 0656-0657, 1400, 3147
SONGGE	0428-0429, 1672, 3487

Brand	Model Code
SOVE	0409-0410, 1478, 2215
SWAN	0524, 1213, 1562, 2990
SUMMER	0427, 1379, 3646, 3998
SUNDURG	0257, 0505, 3124, 3357, 3876
TADIRAN	0246-0251, 0759, 1787
TATUNG	0149-0420, 2980, 3499
TCL	0273-0281, 0570, 0635, 3694, 3782
TECO	0256, 0473-475, 0516, 1193
TIANDI, MICOM	0415, 1452, 2464
TOSHIBA	0107-0117, 0493-0499, 0561, 0562
TOYO	0614, 3123, 3467
TRANE	0227-0232, 0589, 1236, 1587, 1969
UNI-AIR	0222-0224, 0450, 1999
WEILI	0393-0396, 1783
Whirlpool	0164-0170, 0502, 0607, 0608, 1554, 1987
XILENG	0411-0412, 1106, 3625
XINLE	0400-0401, 1095, 1773
YANGTZE	0403, 3663, 3749
YANGZI	0654, 2044
YAOMA	0599, 1024
YINYAN	0326-0331, 0258-0259, 0592-0593, 3358
YORK	0238-0243, 0681, 0695, 0995

K-2E和K-3E代码表